

SPUR GEARS - SPLIT HUB

**64 PITCH
1/8 FACE
1/8 BORE**

20° PRESSURE ANGLE

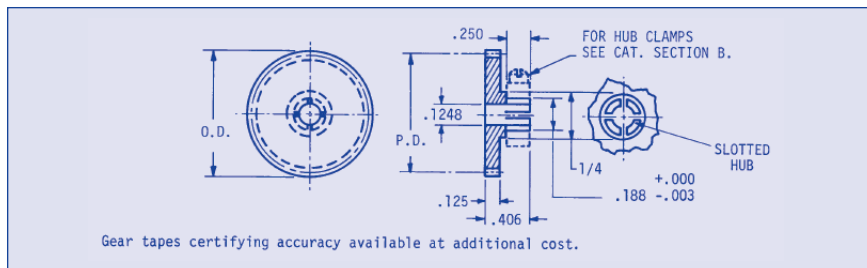

Specifications: Unless otherwise stated, AGMA Quality 10 or better gears will be supplied. When ordering Q12 or Q14 please supply the catalog number and add Q12 or Q14

Gear Class	Total Composite Tolerance	Tooth to Tooth Composite Tolerance	Bore	Pitch Diameter	Outside Diameter
Q10	.001	.0004	+ .0005	- .001	- .002
Q12	.0005	.0003	+ .0003	- .0007	- .0015
Q14	.00025	.0002	+ .0002	- .0005	- .001

ORDER BY CATALOG NUMBER

303 STAINLESS STEEL		2024-T4 ALUMINUM ANODIZED BEFORE CUTTING	GEAR DATA		
Catalog Number	Catalog Number	Number of Teeth	Pitch Diameter	Outside Diameter	
LBS-F1-20	LBA-F1-20	20	.3125	.344	
LBS-F1-21	LBA-F1-21	21	.3281	.359	
LBS-F1-22	LBA-F1-22	22	.3437	.375	
LBS-F1-24	LBA-F1-24	24	.3750	.406	
LBS-F1-25	LBA-F1-25	25	.3906	.422	
LBS-F1-27	LBA-F1-27	27	.4218	.453	
LBS-F1-28	LBA-F1-28	28	.4375	.469	
LBS-F1-30	LBA-F1-30	30	.4687	.500	
LBS-F1-32	LBA-F1-32	32	.5000	.521	
LBS-F1-36	LBA-F1-36	36	.5625	.594	
LBS-F1-40	LBA-F1-40	40	.6250	.656	
LBS-F1-42	LBA-F1-42	42	.6562	.688	
LBS-F1-44	LBA-F1-44	44	.6875	.719	
LBS-F1-48	LBA-F1-48	48	.7500	.781	
LBS-F1-50	LBA-F1-50	50	.7812	.813	
LBS-F1-55	LBA-F1-55	55	.8593	.891	
LBS-F1-56	LBA-F1-56	56	.8750	.906	
LBS-F1-60	LBA-F1-60	60	.9375	.969	
LBS-F1-72	LBA-F1-72	72	1.1250	1.156	
LBS-F1-80	LBA-F1-80	80	1.2500	1.281	
LBS-F1-88	LBA-F1-88	88	1.3750	1.406	
LBS-F1-96	LBA-F1-96	96	1.5000	1.531	
LBS-F1-104	LBA-F1-104	104	1.6250	1.656	
LBS-F1-112	LBA-F1-112	112	1.7500	1.781	
LBS-F1-120	LBA-F1-120	120	1.8750	1.906	

The number of teeth shown does not reflect our entire stock, unlisted teeth, supplied at modest additional cost. 14 1/2° pressure angle, special bores and materials - prices on application.

57L

(800) 243-0986 In CT: (203) 775-4877 info@nordex.com

NORDEX

SPUR GEARS - SPLIT HUB

**64 PITCH
1/8 FACE
3/16 BORE**

20° PRESSURE ANGLE

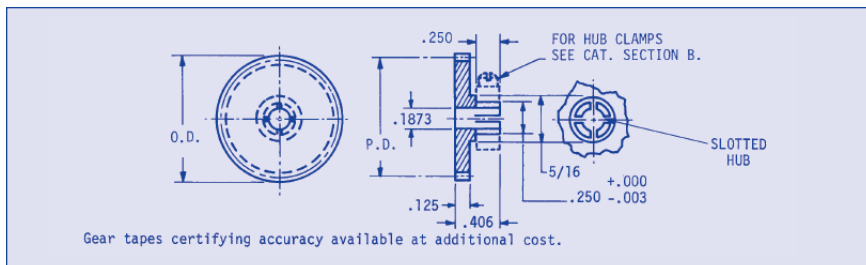

Specifications: Unless otherwise stated, AGMA Quality 10 or better gears will be supplied. When ordering Q12 or Q14 please supply the catalog number and add Q12 or Q14.

Gear Class	Total Composite Tolerance	Tooth to Tooth Composite Tolerance	Bore	Pitch Diameter	Outside Diameter
Q10	.001	.0004	+ .0005	-.001	-.002
Q12	.0005	.0003	+ .0003	-.0007	-.0015
Q14	.00025	.0002	+ .0002	-.0005	-.001

ORDER BY CATALOG NUMBER

303 STAINLESS STEEL	2024-T4 ALUMINUM ANODIZED BEFORE CUTTING	GEAR DATA			
Catalog Number	Catalog Number	Number of Teeth	Pitch Diameter	Outside Diameter	
*LBS-F2-22	*LBA-F2-22	22	.3437	.375	
LBS-F2-23	LBA-F2-23	23	.3593	.391	
LBS-F2-24	LBA-F2-24	24	.3750	.406	
LBS-F2-25	LBA-F2-25	25	.3906	.422	
LBS-F2-26	LBA-F2-26	28	.4375	.469	
LBS-F2-30	LBA-F2-30	30	.4687	.500	
LBS-F2-32	LBA-F2-32	32	.5000	.531	
LBS-F2-36	LBA-F2-36	36	.5625	.594	
LBS-F2-40	LBA-F2-40	40	.6250	.656	
LBS-F2-42	LBA-F2-42	42	.6562	.688	
LBS-F2-44	LBA-F2-44	44	.6875	.719	
LBS-F2-46	LBA-F2-46	46	.7187	.750	
LBS-F2-48	LBA-F2-48	48	.7500	.781	
LBS-F2-50	LBA-F2-50	50	.7812	.813	
LBS-F2-55	LBA-F2-55	55	.8593	.891	
LBS-F2-56	LBA-F2-56	56	.8750	.906	
LBS-F2-60	LBA-F2-60	60	.9375	.969	
LBS-F2-64	LBA-F2-64	64	1.0000	1.031	
LBS-F2-72	LBA-F2-72	72	1.1250	1.156	
LBS-F2-80	LBA-F2-80	80	1.2500	1.281	
LBS-F2-88	LBA-F2-88	88	1.3750	1.406	
LBS-F2-96	LBA-F2-96	96	1.5000	1.531	
LBS-F2-104	LBA-F2-104	104	1.6250	1.656	
LBS-F2-112	LBA-F2-112	112	1.7500	1.781	
LBS-F2-120	LBA-F2-120	120	1.8750	1.906	

The number of teeth shown does not reflect our entire stock, unlisted teeth, supplied at modest additional cost. 14 1/2° pressure angle, special bores and materials - prices on application

*Gear hob cuts into 5/16ths hub.

NORDEX

(800) 243-0986 In CT: (203) 775-4877 info@nordex.com

58L

SPUR GEARS - SPLIT HUB

**64 PITCH
1/8 FACE
1/4 BORE**

20° PRESSURE ANGLE

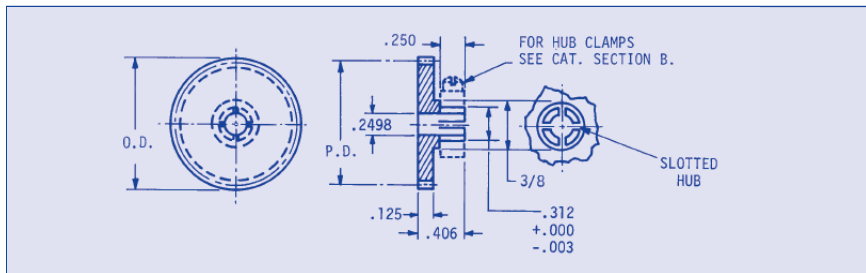

Specifications: Unless otherwise stated, AGMA Quality 10 or better gears will be supplied. When ordering Q12 or Q14 please supply the catalog number and add Q12 or Q14.

Gear Class	Total Composite Tolerance	Tooth to Tooth Composite Tolerance	Bore	Pitch Diameter	Outside Diameter
Q10	.001	.0004	+ .0005	- .001	- .002
Q12	.0005	.0003	+ .0003	- .0007	- .0015
Q14	.00025	.0002	+ .0002	- .0005	- .001

ORDER BY CATALOG NUMBER

303 STAINLESS STEEL	2024-T4 ALUMINUM ANODIZED BEFORE CUTTING	GEAR DATA		
Catalog Number	Catalog Number	Number of Teeth	Pitch Diameter	Outside Diameter
*LBS-F3-22	*LBA-F3-22	22	.3437	.375
*LBS-F3-23	*LBA-F3-23	23	.3593	.391
*LBS-F3-24	*LBA-F3-24	24	.3750	.406
*LBS-F3-25	*LBA-F3-25	25	.3906	.422
*LBS-F3-26	*LBA-F3-26	26	.4062	.438
LBS-F3-27	LBA-F3-27	27	.4218	.453
LBS-F3-28	LBA-F3-28	28	.4375	.469
LBS-F3-29	LBA-F3-29	29	.4531	.484
LBS-F3-30	LBA-F3-30	30	.4687	.500
LBS-F3-32	LBA-F3-32	32	.5000	.531
LBS-F3-34	LBA-F3-34	34	.5312	.563
LBS-F3-36	LBA-F3-36	36	.5625	.594
LBS-F3-38	LBA-F3-38	38	.5937	.625
LBS-F3-40	LBA-F3-40	40	.6250	.656
LBS-F3-42	LBA-F3-42	42	.6562	.688

* Gear hob cuts into 3/8ths hub.

20° PRESSURE ANGLE

ORDER BY CATALOG NUMBER

303 STAINLESS STEEL		2024-T4 ALUMINUM ANODIZED BEFORE CUTTING		GEAR DATA	
303 Catalog Number	2024-T4 Catalog Number	Number of Teeth	Pitch Diameter	303 Outside Diameter	2024-T4 Outside Diameter
LBS-F3-44	LBA-F3-44	44	.6875	.719	
LBS-F3-46	LBA-F3-46	46	.7187	.750	
LBS-F3-48	LBA-F3-48	48	.7500	.781	
LBS-F3-50	LBA-F3-50	50	.7812	.813	
LBS-F3-55	LBA-F3-55	55	.8593	.891	
LBS-F3-56	LBA-F3-56	56	.8750	.906	
LBS-F3-60	LBA-F3-60	60	.9375	.969	
LBS-F3-64	LBA-F3-64	64	1.0000	1.031	
LBS-F3-72	LBA-F3-72	72	1.1250	1.156	
LBS-F3-80	LBA-F3-80	80	1.2500	1.281	
LBS-F3-88	LBA-F3-88	88	1.3750	1.406	
LBS-F3-96	LBA-F3-96	96	1.5000	1.531	
LBS-F3-104	LBA-F3-104	104	1.6250	1.656	
LBS-F3-112	LBA-F3-112	112	1.7500	1.781	
LBS-F3-120	LBA-F3-120	120	1.8750	1.906	
LBS-F3-127	LBA-F3-127	127	1.9843	2.016	
LBS-F3-128	LBA-F3-128	128	2.0000	2.031	
LBS-F3-136	LBA-F3-136	136	2.1250	2.156	
LBS-F3-144	LBA-F3-144	144	2.2500	2.281	
LBS-F3-160	LBA-F3-160	160	2.5000	2.531	
LBS-F3-176	LBA-F3-176	176	2.7500	2.781	
LBS-F3-192	LBA-F3-192	192	3.0000	3.031	
LBS-F3-208	LBA-F3-208	208	3.2500	3.281	
LBS-F3-224	LBA-F3-224	224	3.5000	3.531	
LBS-F3-240	LBA-F3-240	240	3.7500	3.781	
LBS-F3-256	LBA-F3-256	256	4.0000	4.031	
LBS-F3-264	LBA-F3-264	264	4.1250	4.156	

The number of teeth shown does not reflect our entire stock, unlisted teeth supplied at modest additional cost. 14 1/2° pressure angle, special bores and materials - price on application.
Discounts available depending on quantity.

REFERENCE INFORMATION:

If you encounter the problem of making a pair of gears fit a pre-established center distance (and the gear characteristics are unknown), refer to the "Gear Selection Charts" in the technical section of this catalog. There you will find the method by which this can be done with appropriate examples.